

# 2-position 2-way Subplate/modular Leak-free Direct-operated Solenoid Valve

## Technical parameter



Solenoid controls the spool open/closed, the fluid can bi-directionally flows or cut-off. Normally closed.

## Technical parameter ( Please consult factory if your application is out of below range )

|                     |      |   |
|---------------------|------|---|
| Model               |      | HY-AS6, HY-ZS6, 10                          |
| Mounting            |      | Free, recommended for horizontal installing |
| Storage temperature | (°C) | -20 ~ +60                                   |
| Working temperature | (°C) | -20 ~ +50                                   |
| Weight              | (kg) | 1.8(ASP6、AS6) 2.8(ZSW6) 7(ZSW10)            |

## Hydraulic parameter

|                           |                      |   |      |
|---------------------------|----------------------|---|------|
| Max working pressure      | (MPa)                | 35  |      |
| Specifications            |                      | NG6   | NG10 |
| Max flow rate             | (L/min)              |   |      |
| Working fluid             |                      | Mineral hydraulic oil, phosphate  |      |
| Fluid temp range          | (°C)                 | -20~+70   |      |
| Viscosity range           | (mm <sup>2</sup> /s) | 12~320  |      |
| Minimum fluid cleanliness |                      | Maximum permissible degree of pressure fluid contamination to NAS 1638 to class 9 recommended filter $\beta_{10} \geq 75$ . |      |

## Hydraulic symbol

|                         |       |                |
|-------------------------|-------|----------------|
| Voltage type            |       | Direct current |
| Adaptable voltage       | ( V ) | 24             |
| Allowed residue         | (%)   | < 5            |
| Float Voltage step-down | (%)   | ± 10           |
| IP class                |       | IP65           |

# 2-position 2-way Subplate/modular Leak-free Direct-operated Solenoid Valve

## Ordering code

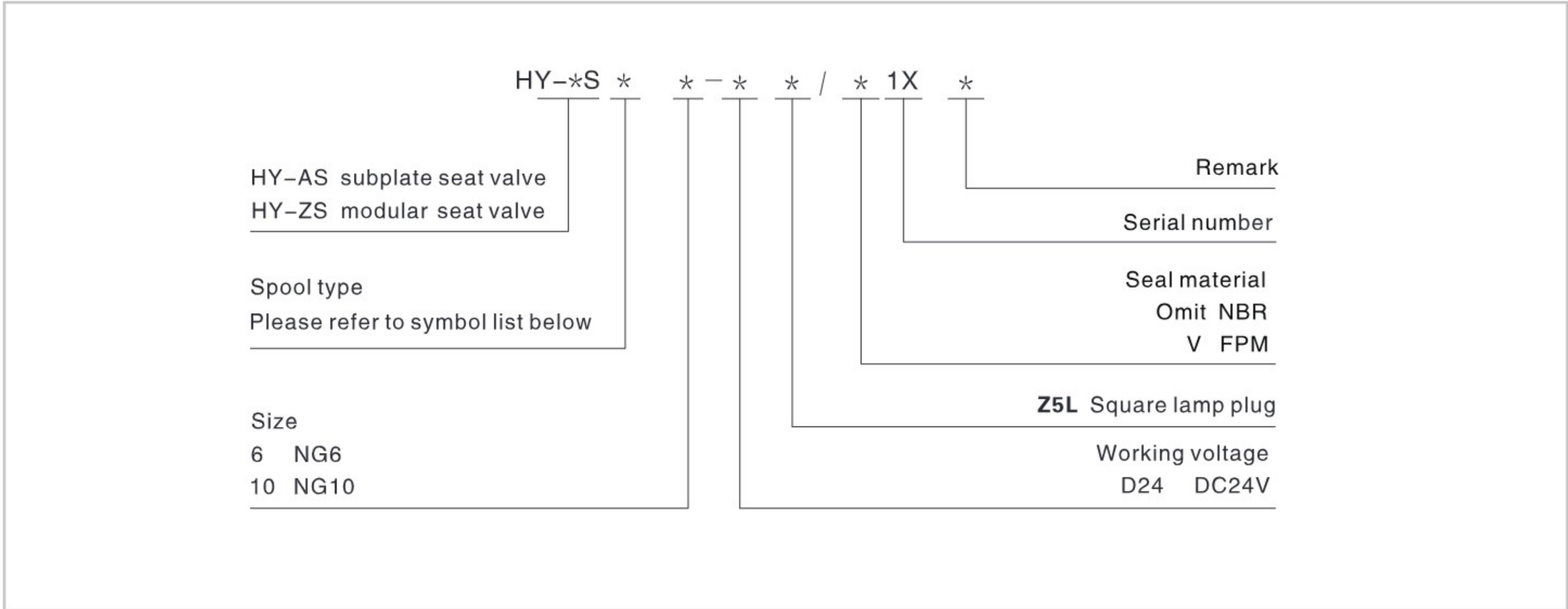

## Hydraulic symbol

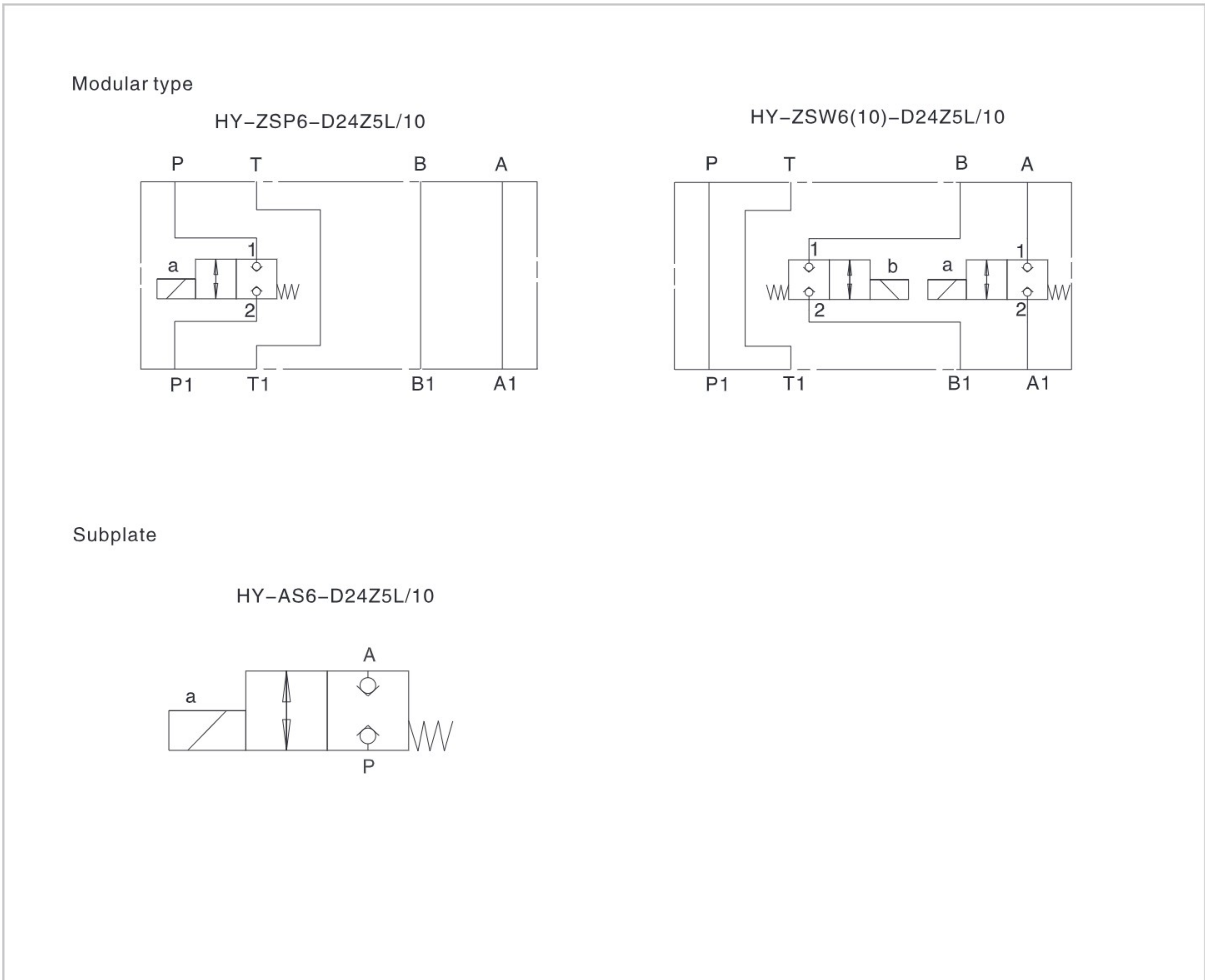

# 2-position 2-way Subplate/modular Leak-free Direct-operated Solenoid Valve

NG6 modular type performance curve (Oil HLP46 tested at 40°C ± 5°C )

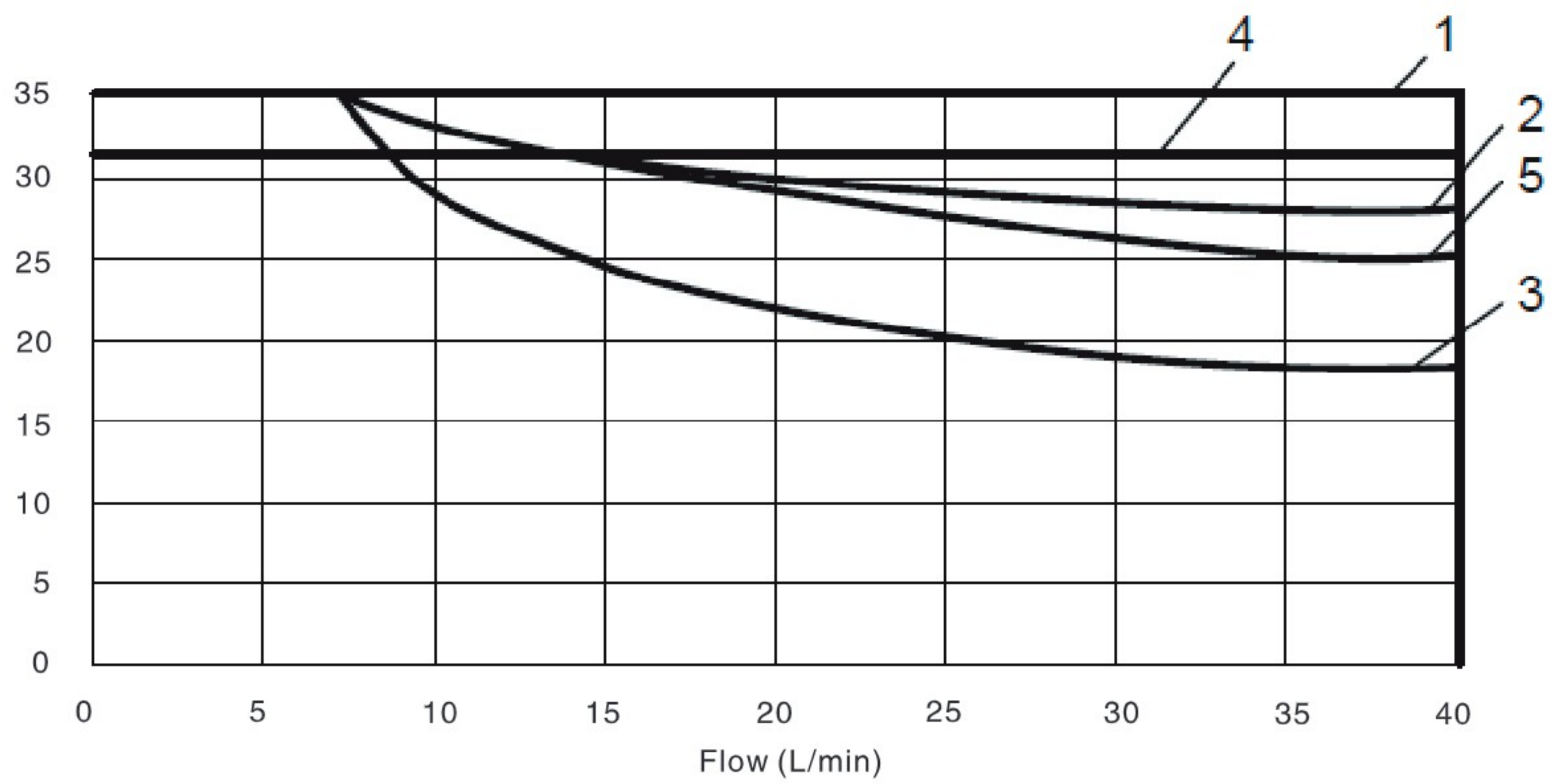
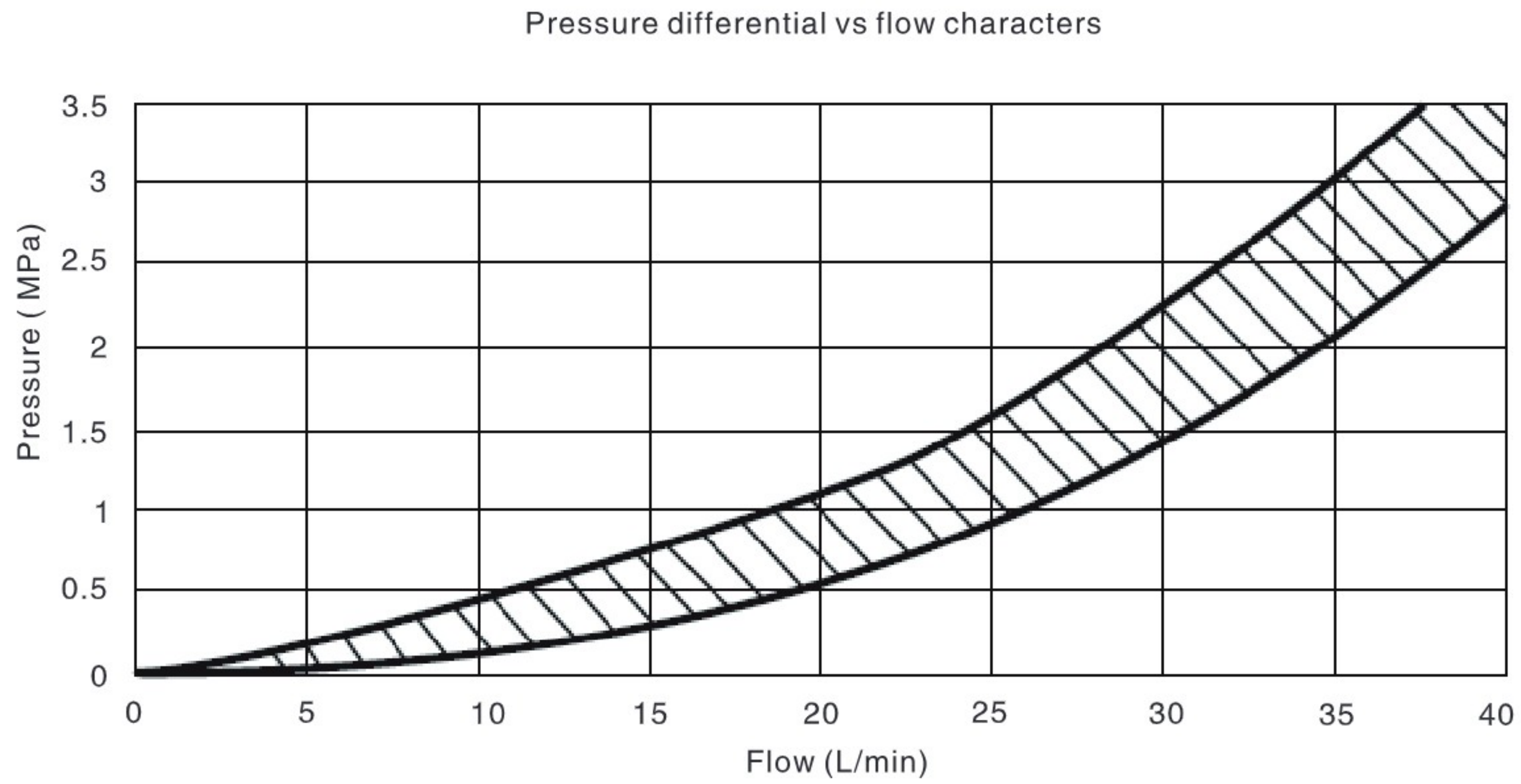

| Flow direction    | 1 → 2 | 2 → 1 |
|-------------------|-------|-------|
| HY-ZSP6-D24Z5L/10 | 1     | 2     |
| HY-ZSW6-D24Z5L/10 | 4     | 5     |

# 2-position 2-way Subplate/modular Leak-free Direct-operated Solenoid Valve

## External dimension

HY-ZSP6-D24Z5L/10

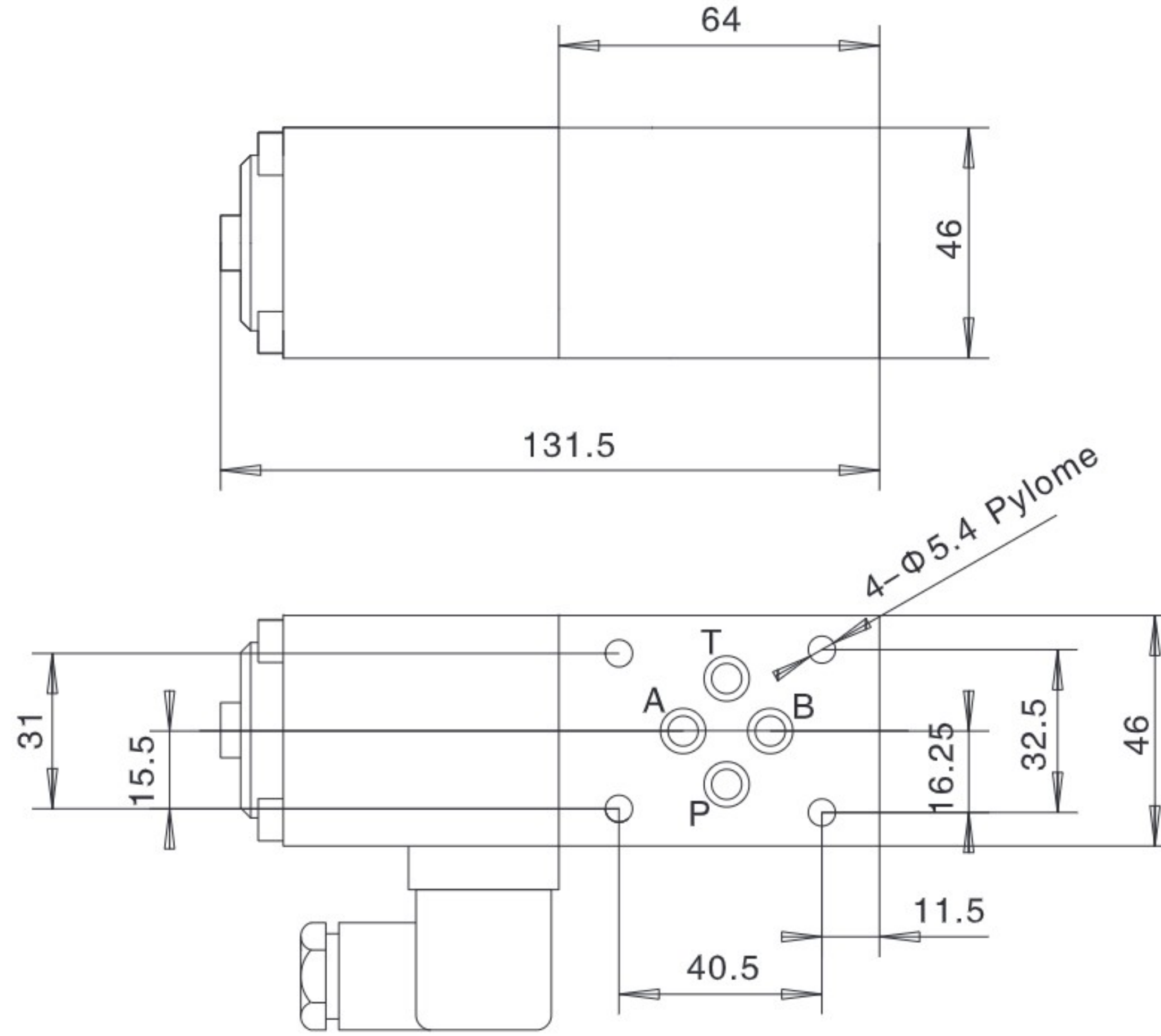

HY-ZSW6(10)-D24Z5L/10

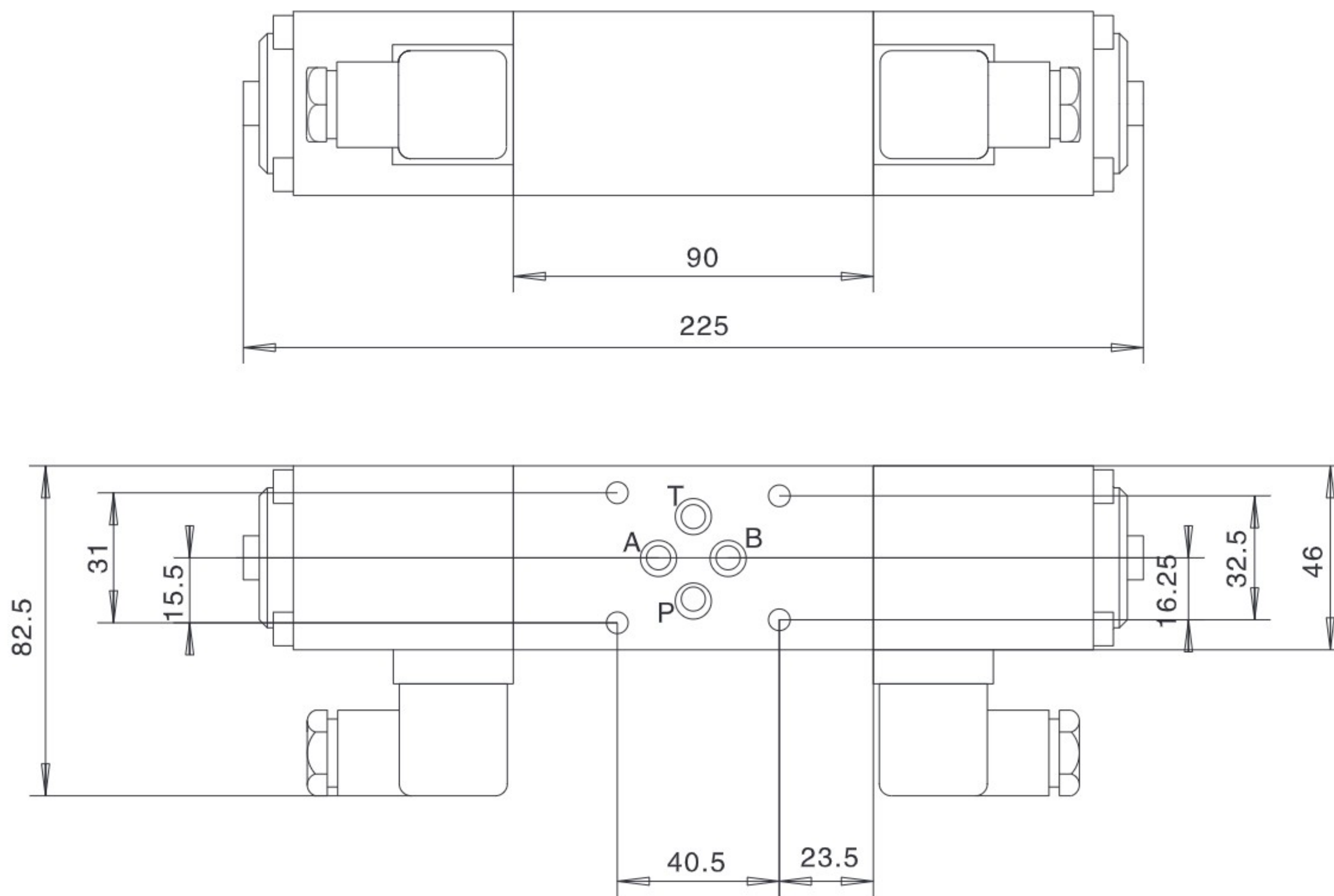

# 2-position 2-way Subplate/modular Leak-free Direct-operated Solenoid Valve

## Sub-plate mounting

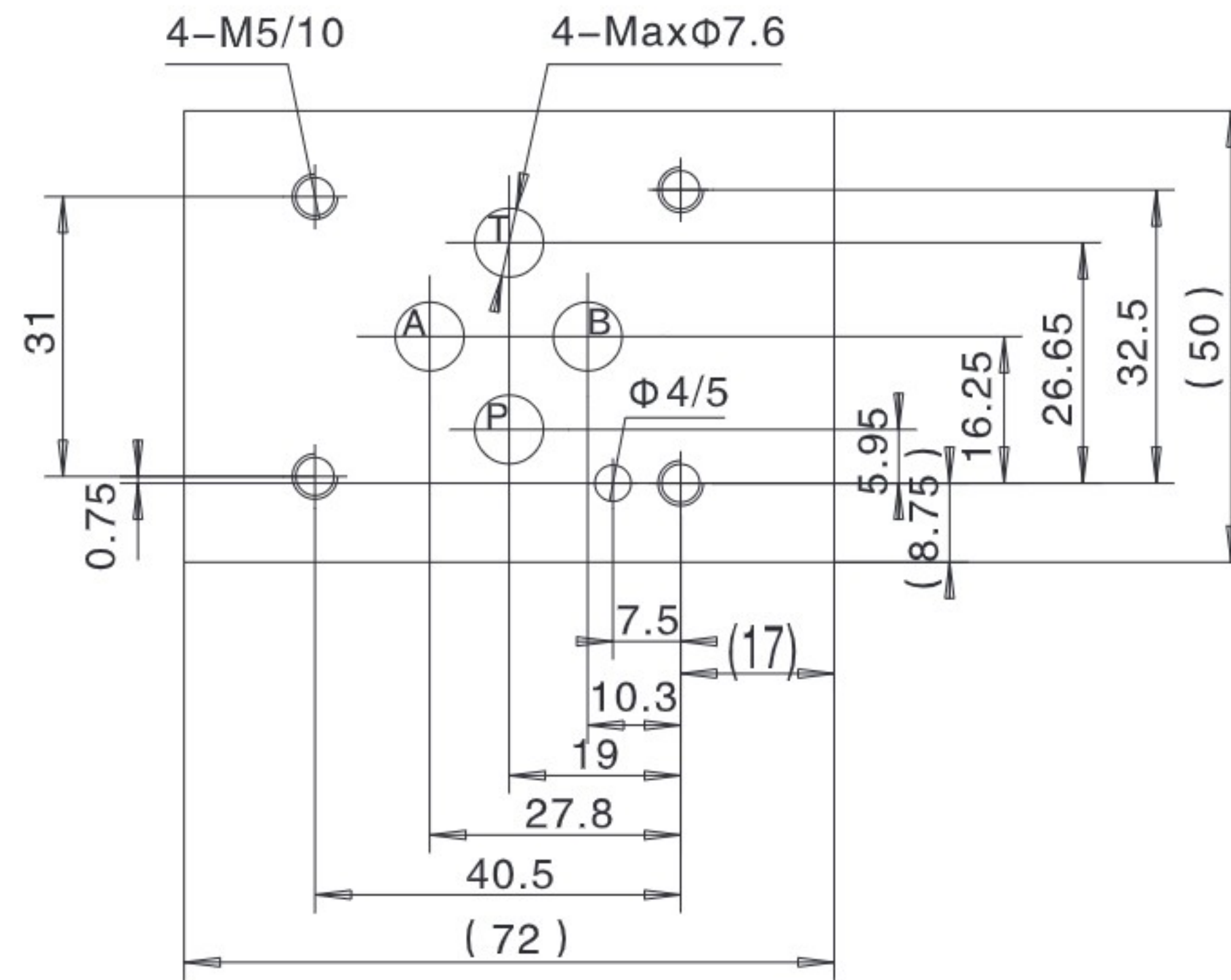

Note:

1. It can be mounted in any direction, but horizontal installation is recommended.
2. The mounting surface must be flat within 0.01/100mm and roughness Ra 0.8

## NG10 modular type performance curve (Oil HLP46 tested at 40 ± 5°C)

Pressure differential vs flow characters

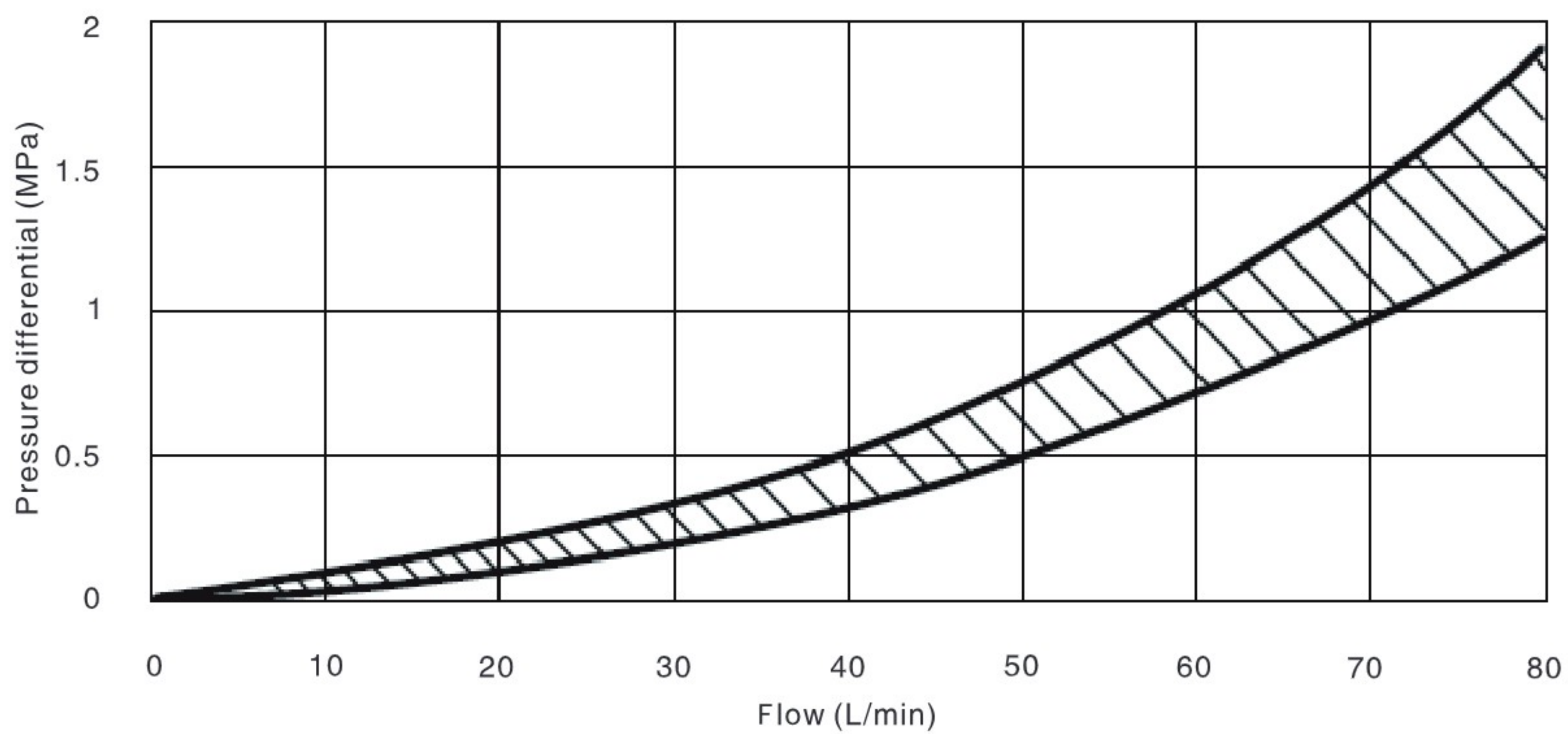

# 2-position 2-way Subplate/modular Leak-free Direct-operated Solenoid Valve

F.7.6

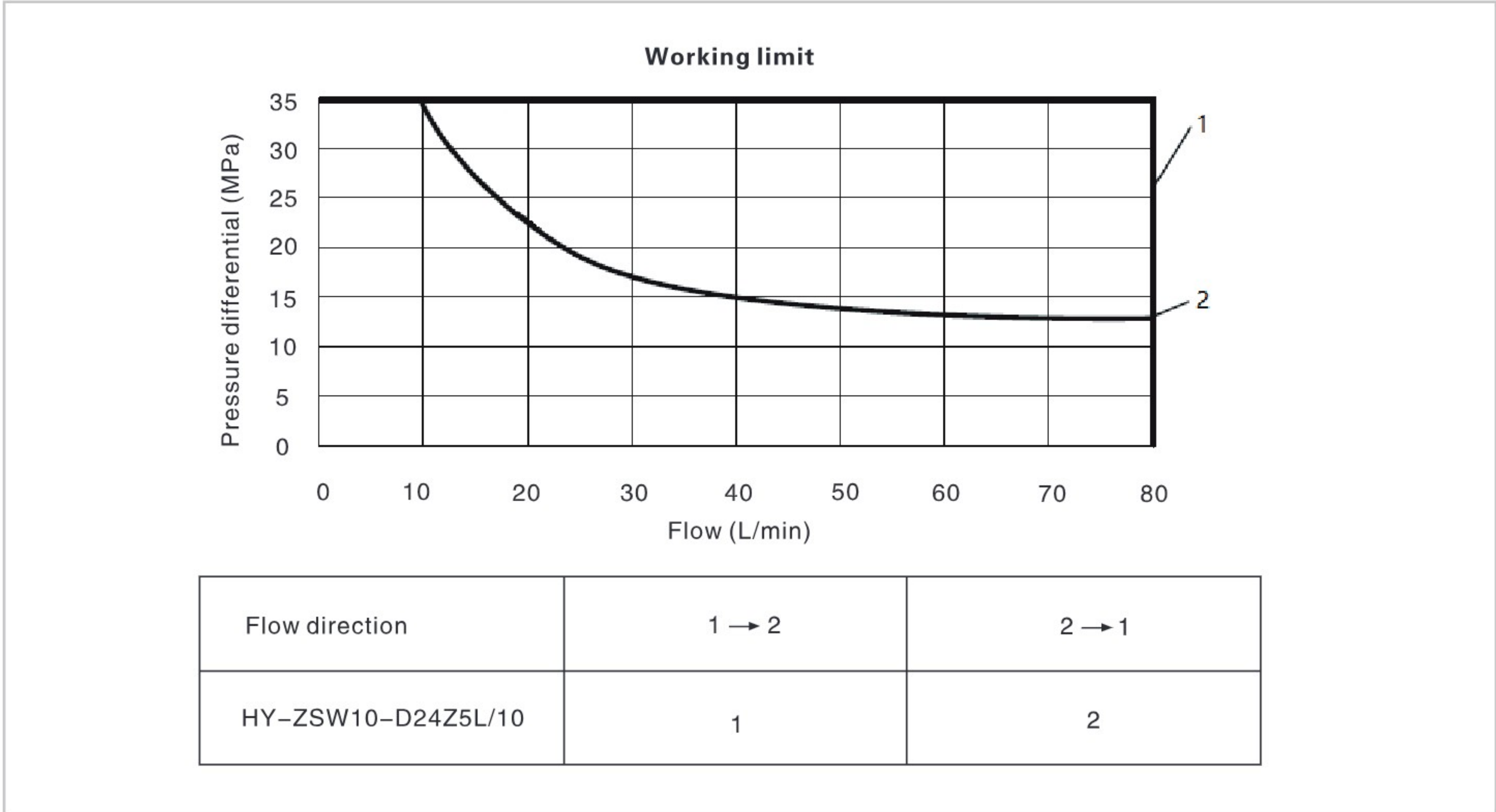

## External dimension

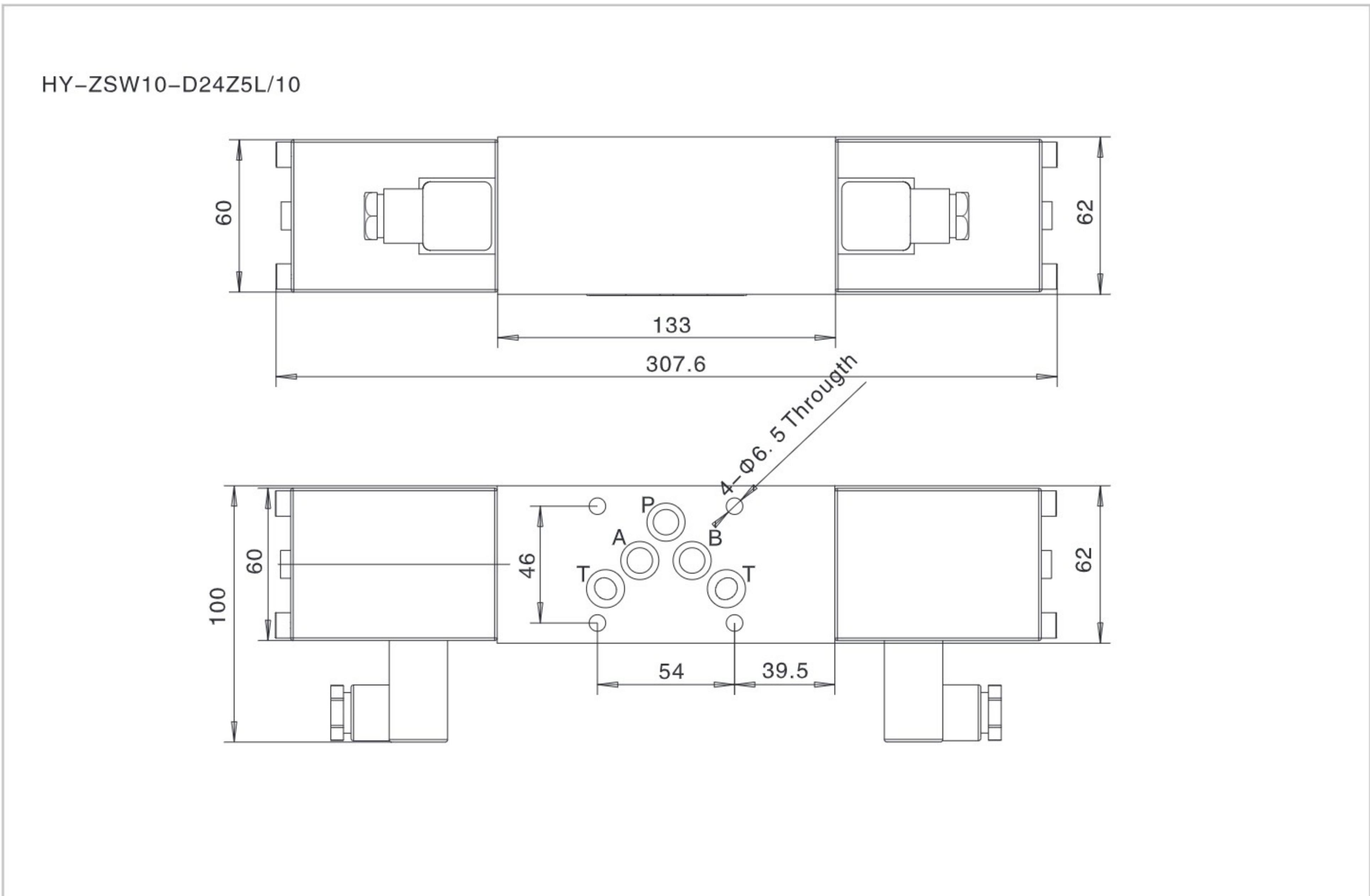

# 2-position 2-way Subplate/modular Leak-free Direct-operated Solenoid Valve

## Sub-plate mounting

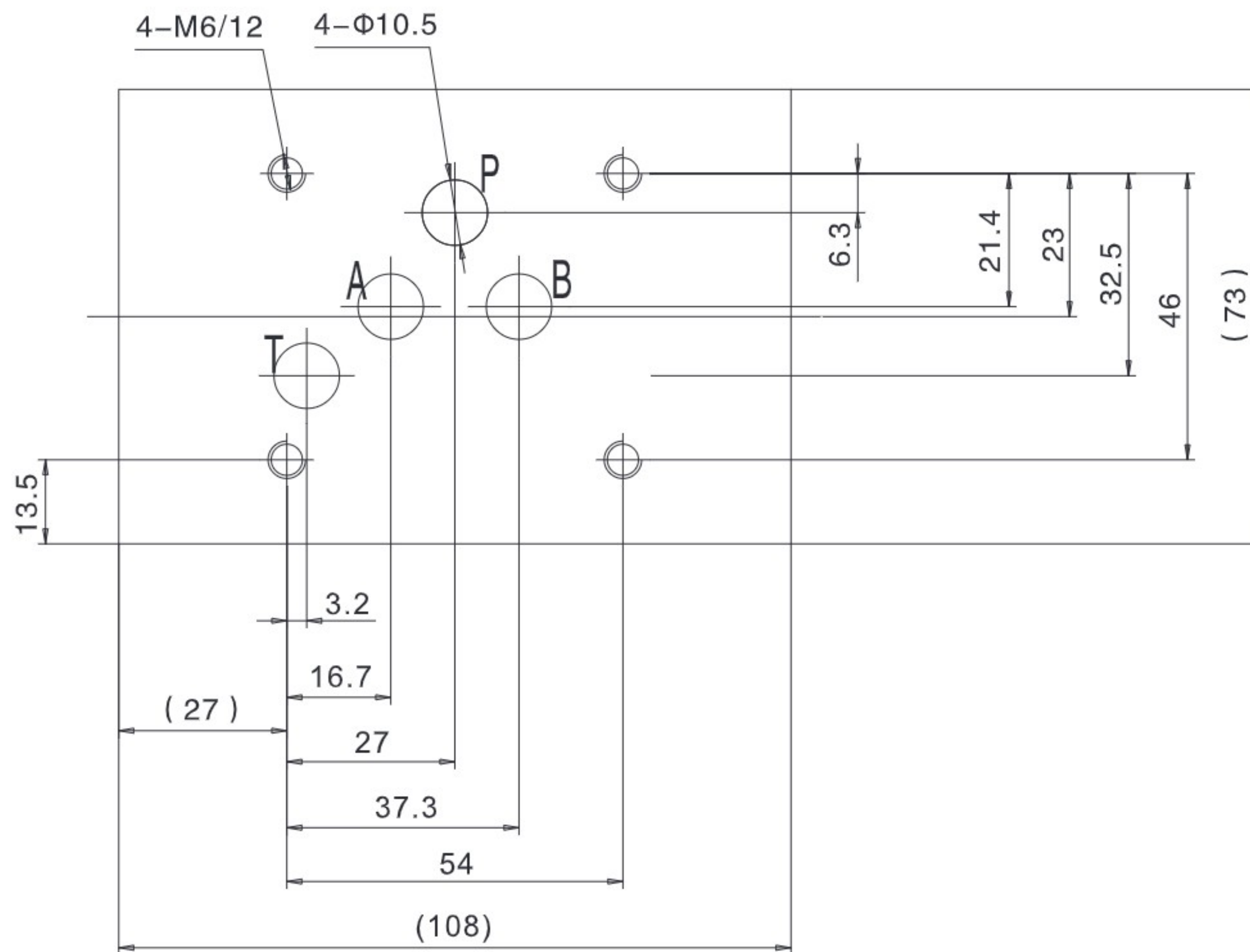

Note:

1. It can be mounted in any direction, but horizontal installation is recommended.
2. The mounting surface must be flat within 0.01/100mm and roughness Ra 0.8

## NG6 modular type performance curve (Oil HLP46 tested at 40 ± 5°C)

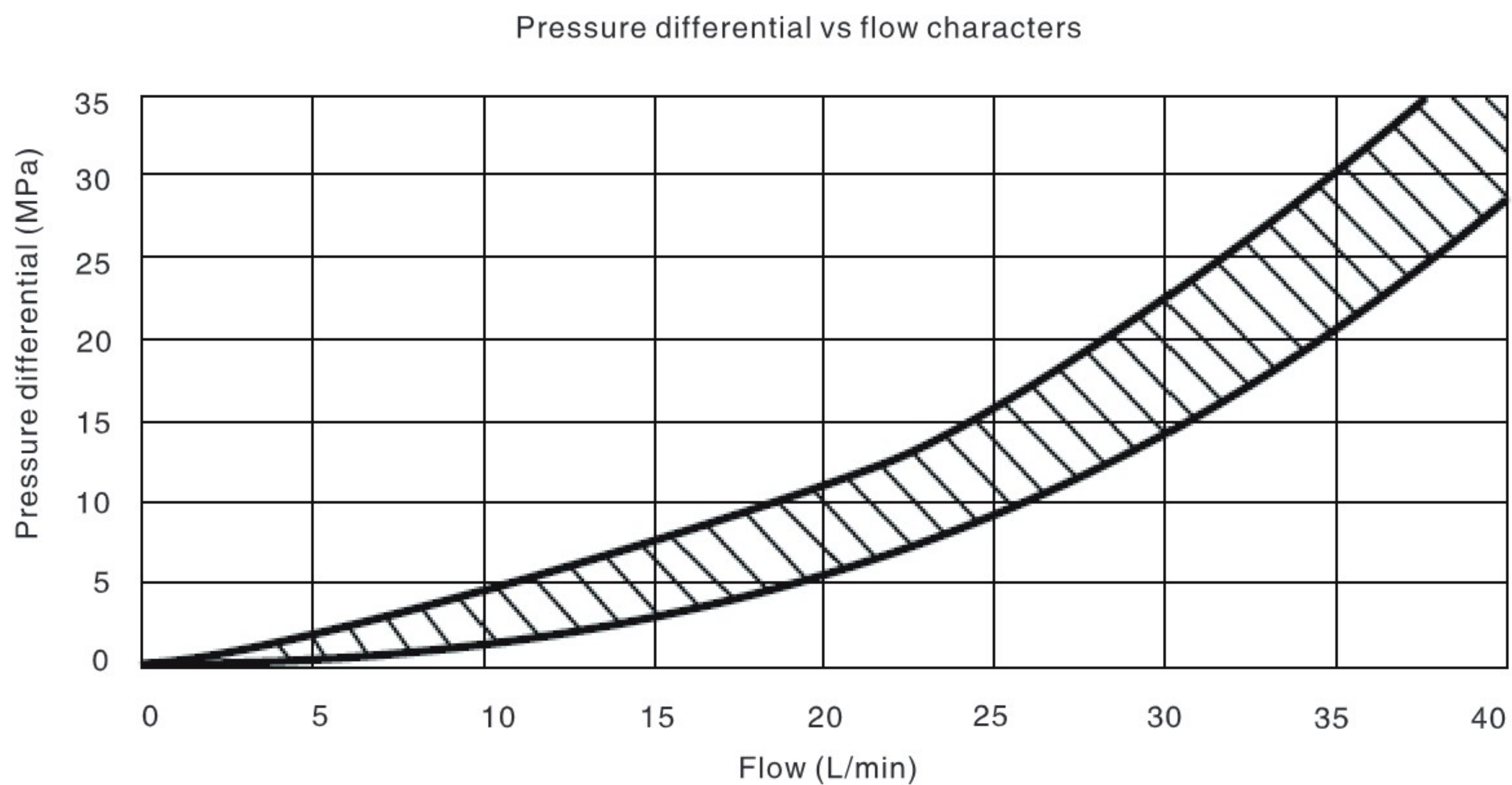

# 2-position 2-way Subplate/modular Leak-free Direct-operated Solenoid Valve

F.7.8

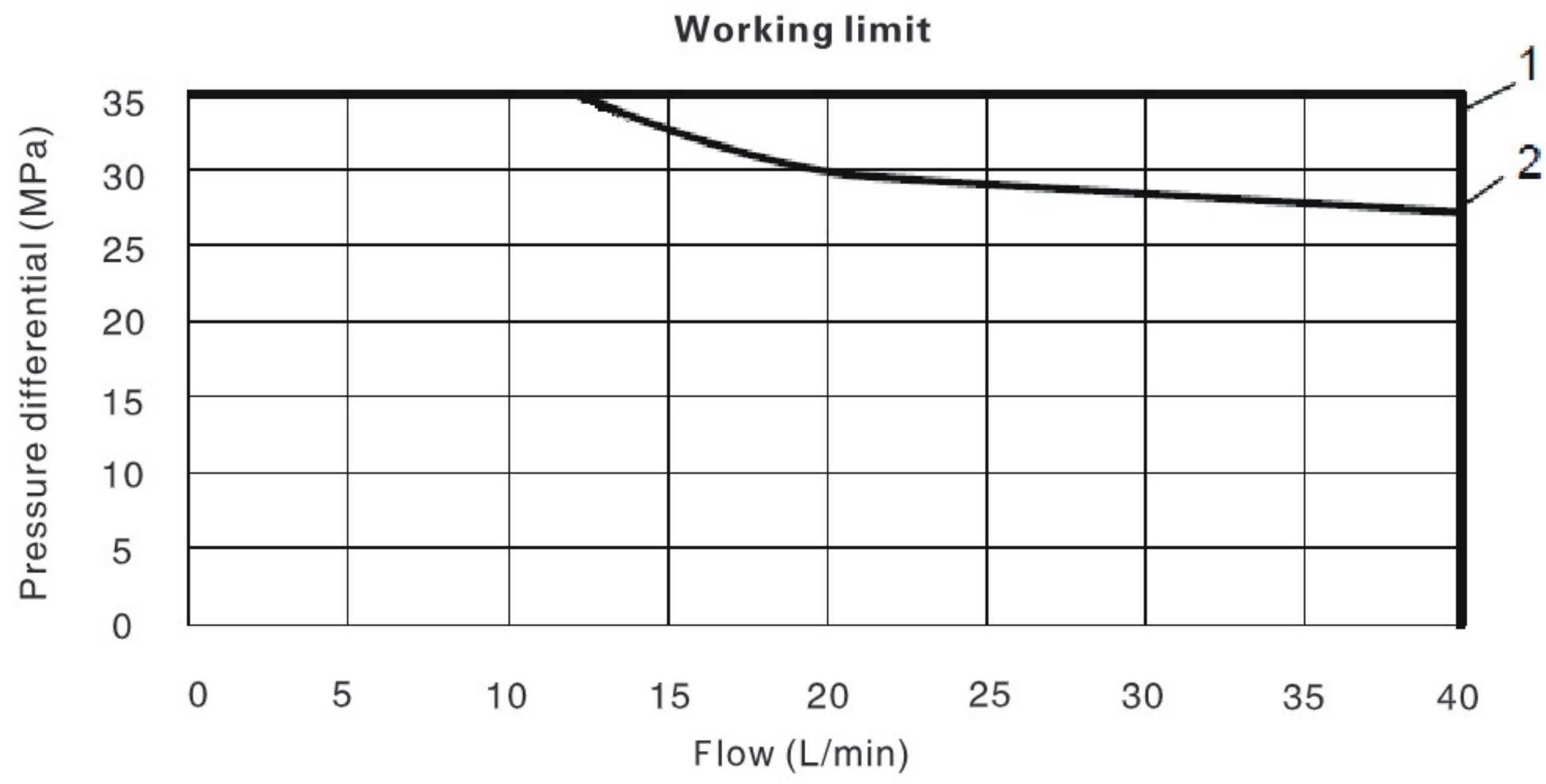

|                  |       |       |
|------------------|-------|-------|
| Flow direction   | P → A | A → P |
| HY-AS6-D24Z5L/10 | 1     | 2     |

## External dimension

HY-AS6-D24Z5L/10

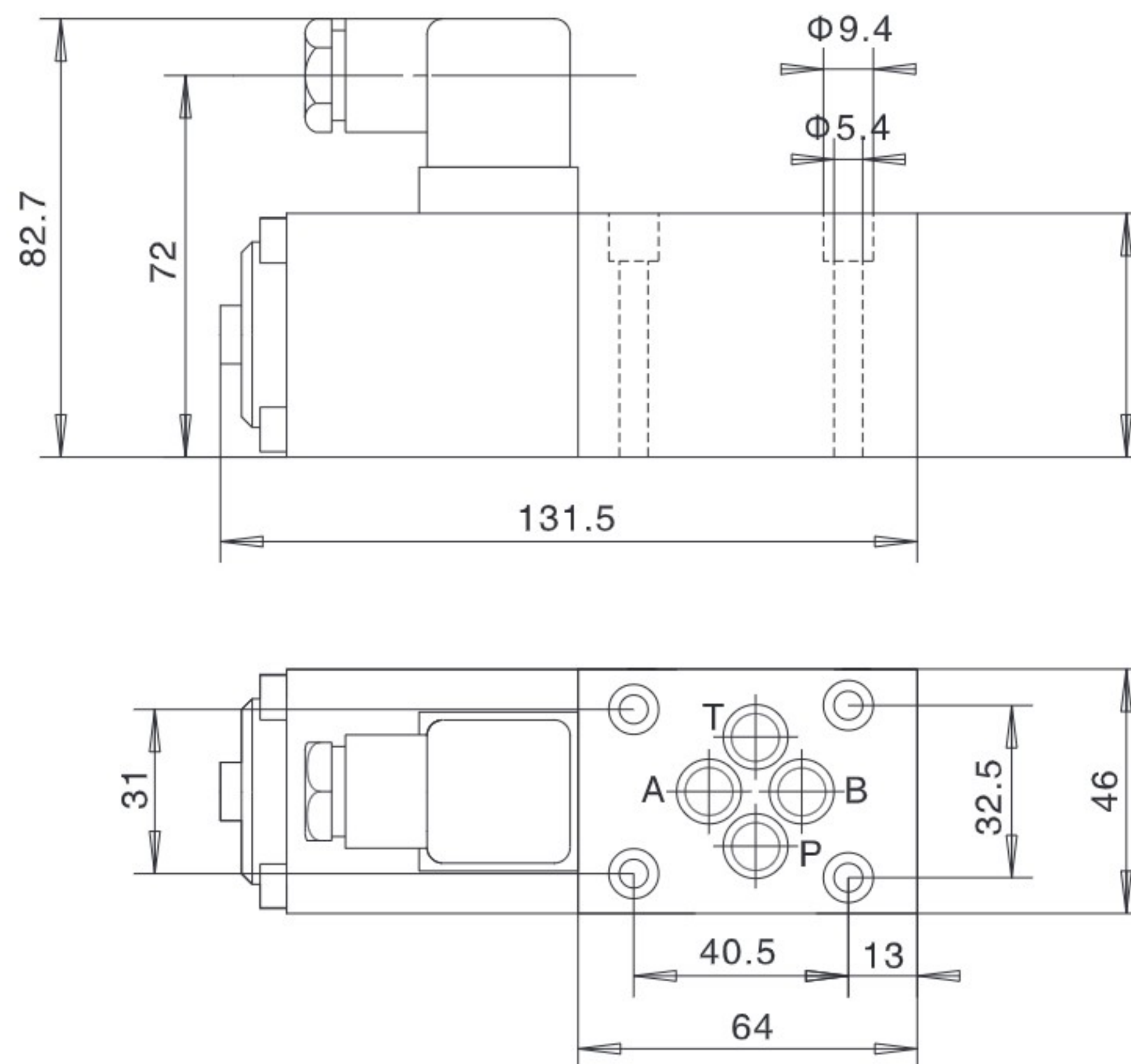



# 2-position 2-way Subplate/modular Leak-free Direct-operated Solenoid Valve

## Sub-plate mounting

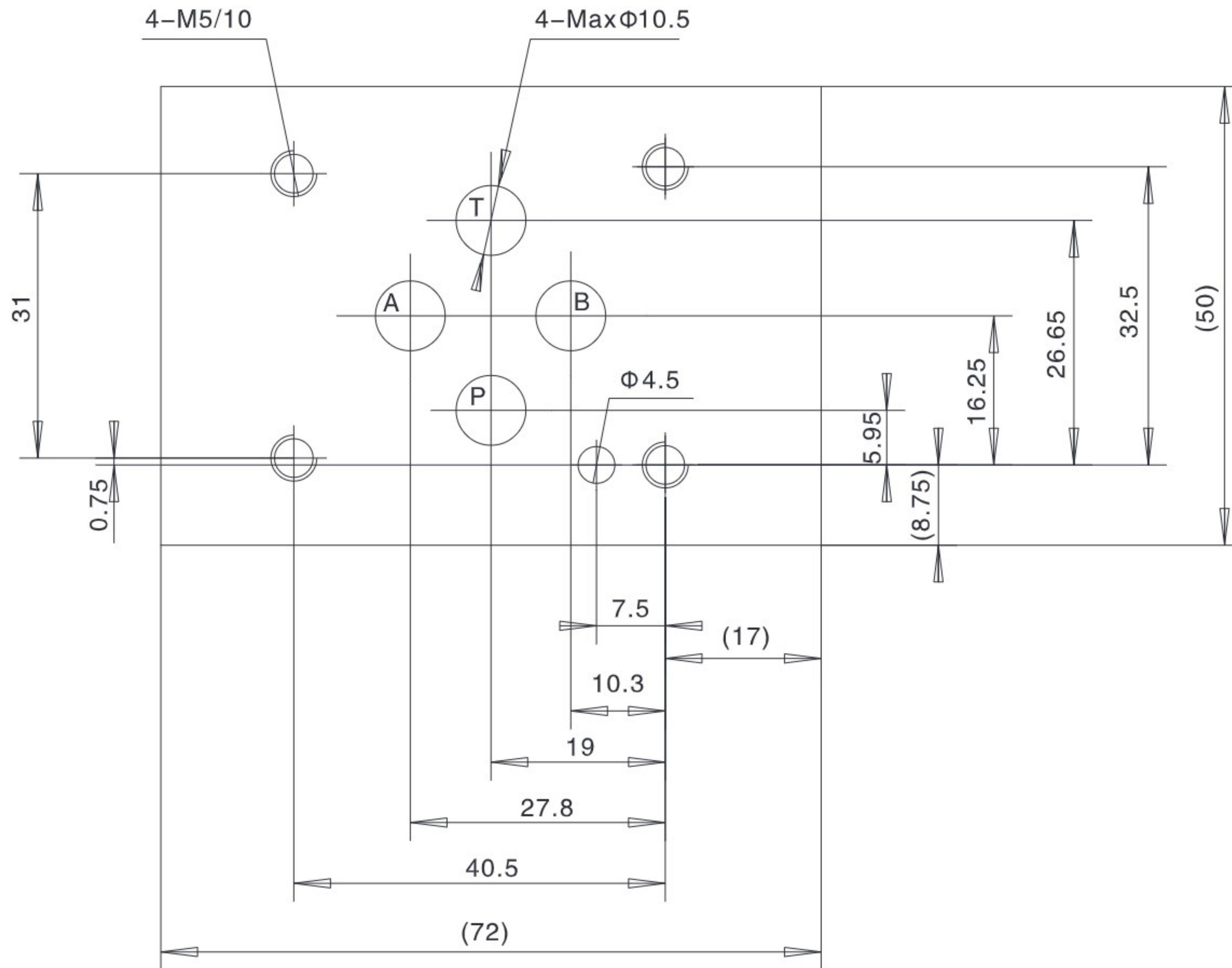

| Mounting screw | Qty | Tighten torque |
|----------------|-----|----------------|
| M5 x 45-10.9   | 4   | 9Nm            |

**Note:**

1. It can be mounted in any direction, but horizontal installation is recommended.
2. The mounting surface must be flat within 0.01/100mm and roughness Ra 0.8